

Installation

1. Switch off ignition and remove the key.
2. The installation of the Interface PCCM can be done at any optical connector in the car.
3. Disconnect the fibre optical plugs e.g. from the connector of the car amplifier. Release the fibre optic cable from the housing (pic.2). Afterwards push out the blue locking (pic.3), and then pull out the fibre optic from the output (!) (see the right arrow on pic.4), while carefully bending the clip with a small screw driver. Then put this fibre optic into the connector from the enclosed fibre optic cable kit (pic.5, this connector must lead to the input of interface 1610 on its' other end via the fibre optic!!) The remaining fibre optic without connector now has to be plugged into the open slot (pic.6). With that, the fibre optic ring must be closed entirely again!

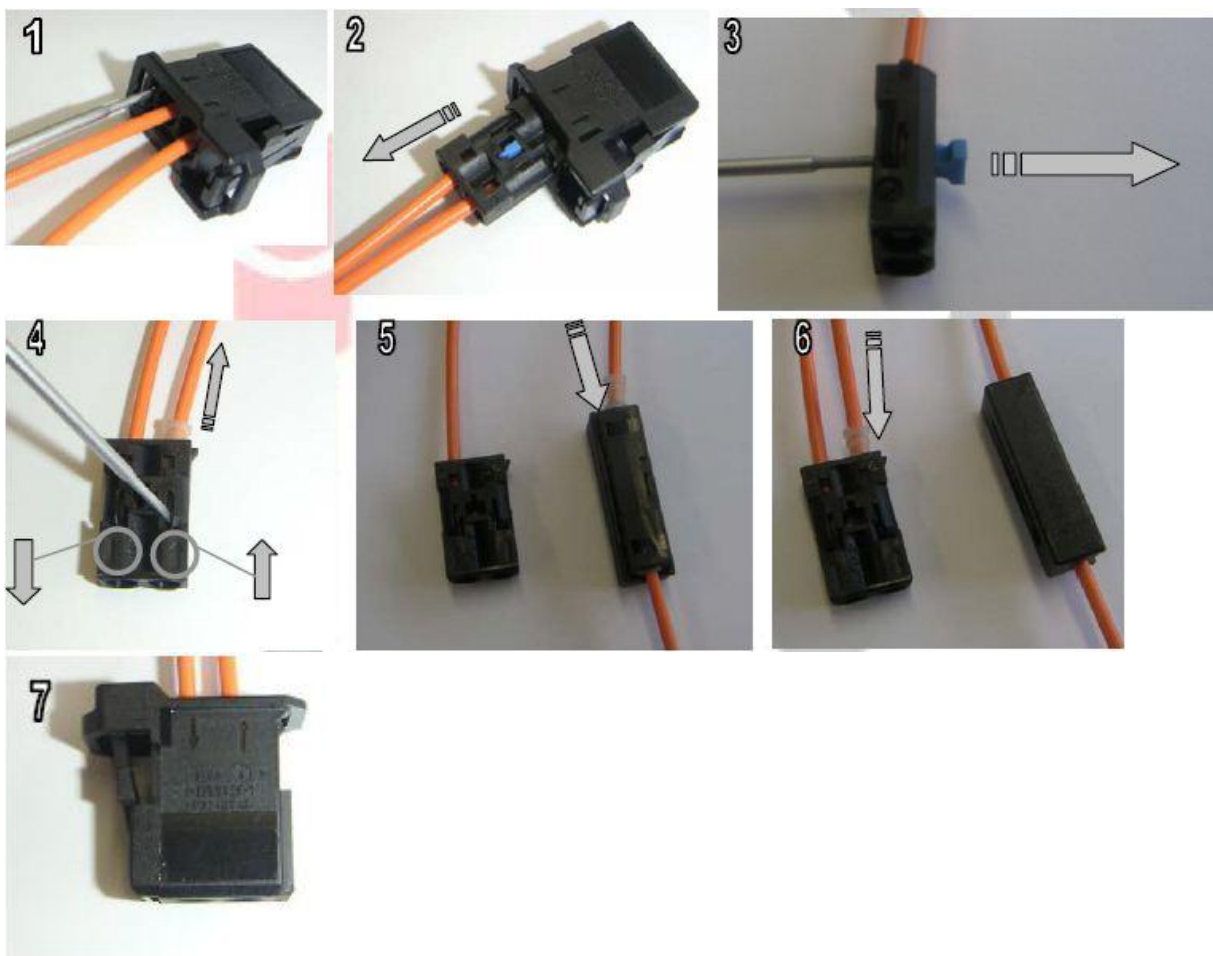

4. Re-connect the small fibre optics connector with the housing and connect it to open connector of the chosen AUDI component, e.g. the amplifier.
5. Connect the remaining fibre optics connector (pic.7) with the counterpart at the interface 1610. (page 12 pic.1 connector A)
6. Now connect the black wire from the harness with ground, the red one with “permanent” +12V.

7. Connect the iPod® cable „connector D” to the interface “connector B” and the iPod® to “connector E”.(page 12 picture 1 & 2).

Place the iPod® connector E to a proper place in the car.

Operating

To activate the interface PCCM you press the button “CD/TV”, and then source (Quelle in the pic.). Choose “Audi music interface”. If there already is an iPod® connected, it will be initialised automatically, then the iPod® display shows “AUX”.

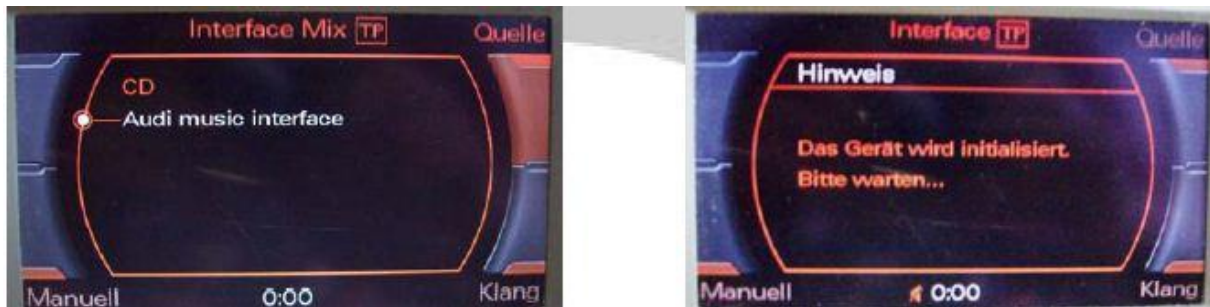

By choosing “Upwards” (Aufwärts in the pic.) you come to the iPod® structure menu (Playlists, Folder, Artists, etc.). The selected menu or track will be selected by pressing the MMI controller.



If another source (e.g. radio) is selected or the system is muted, the play mode of the iPod® will be stopped.

Service notes

This unit does not need any servicing.

Do not open the housing. There are no user-serviceable parts inside.

Wipe gently with a dry cloth over the surface to clean the unit. If there is more tough dirt, first use a light wet

cloth and then uses a dry one. Never use corrosive cleaners to clean the unit.

Technical data

Software release: SW 1.0.0

Power supply: 12 V DC

Working Voltage: 10,0 – 14,6 V DC

Quiescent current: <2 mA

Temperature range: -40 - +85 °C

Weight: 0,168 kg

Dimensions: 135 x 90 x 35 mm